

DETALHE PLACA 02 S/ESC

DETALHE PLACA 03 S/ESC

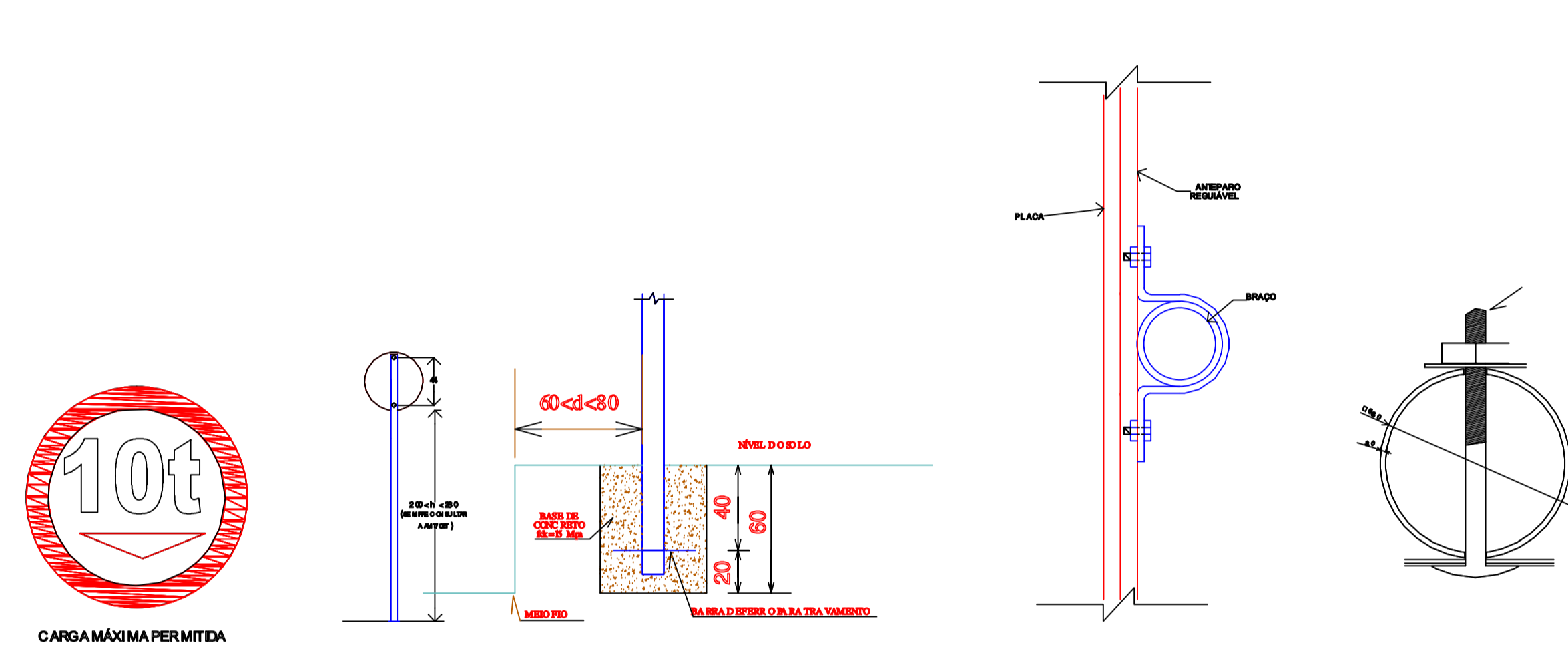
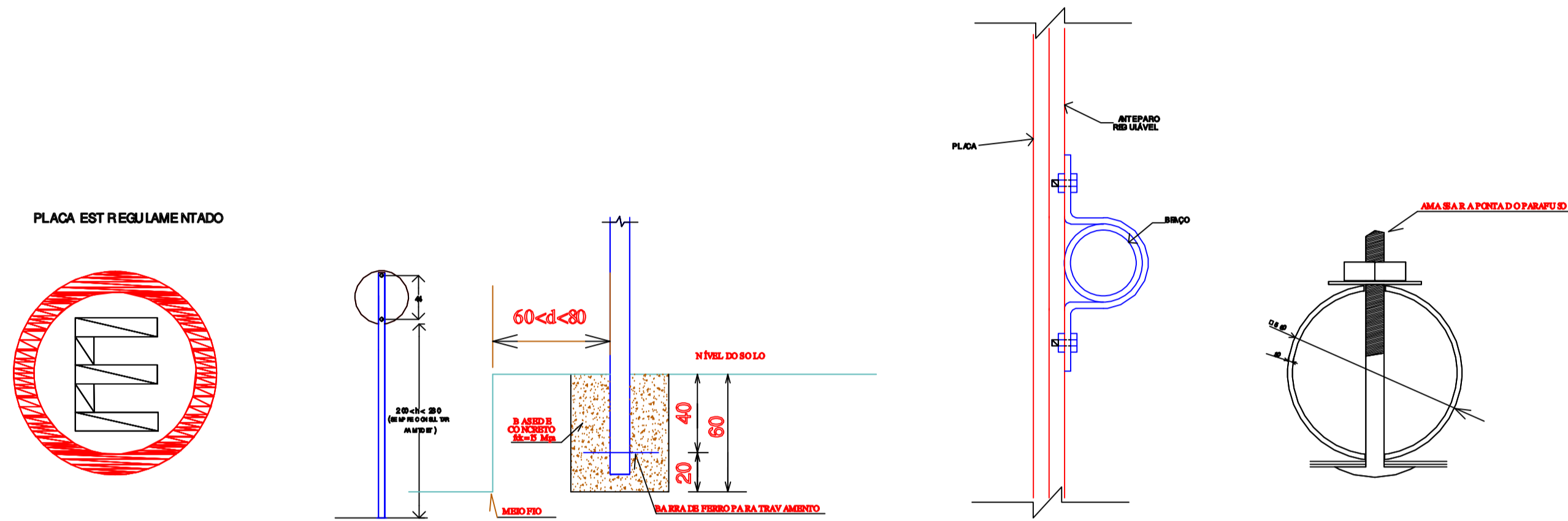

DETALHE PLACA 05 S/ESC

DETALHE PLACA 07 S/ESC

VER MEMORIAL DESCRITIVO

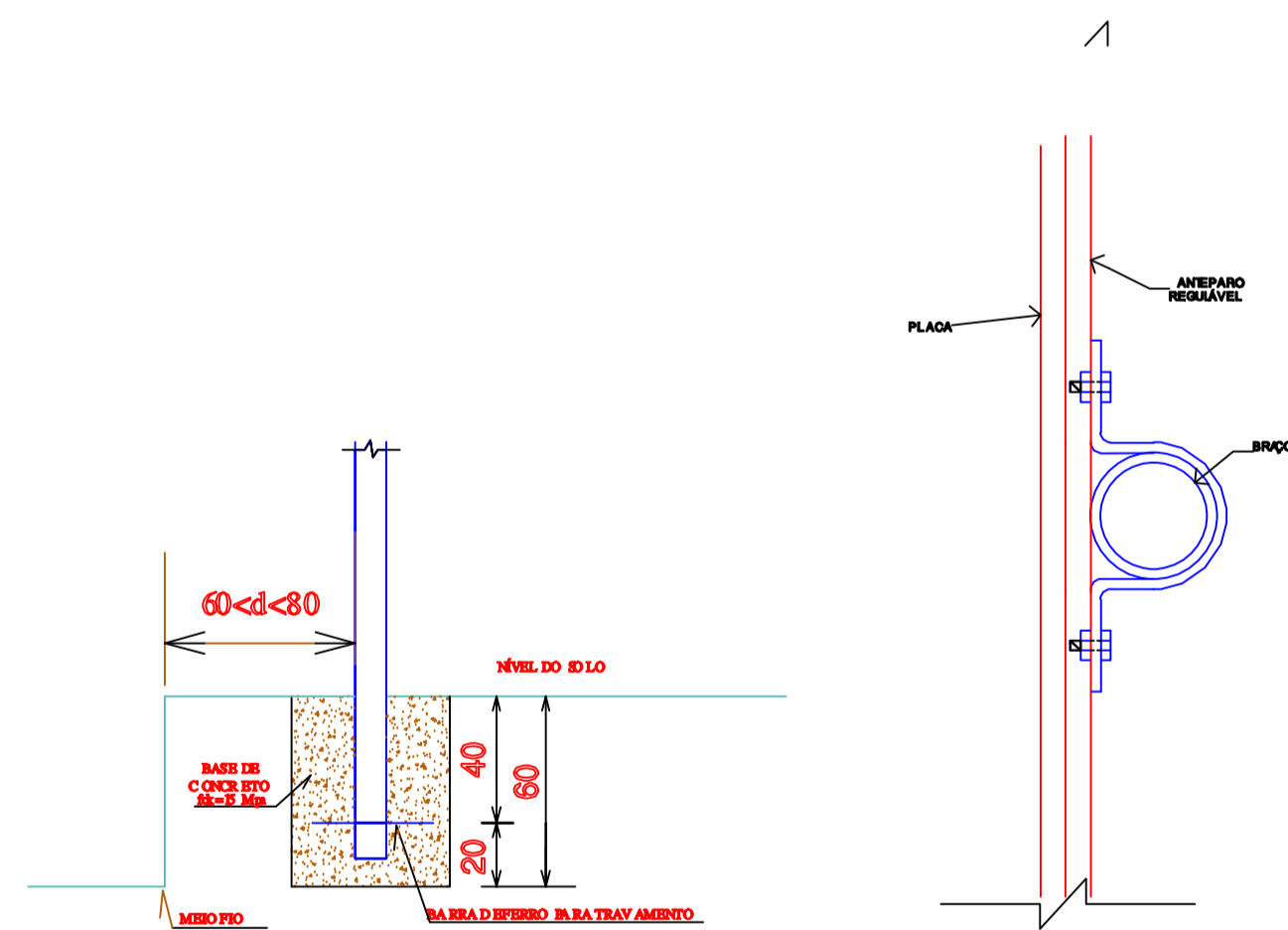
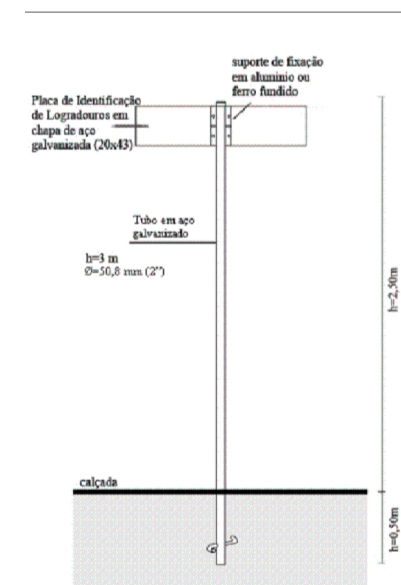

DETALHE PLACA 08 S/ESC

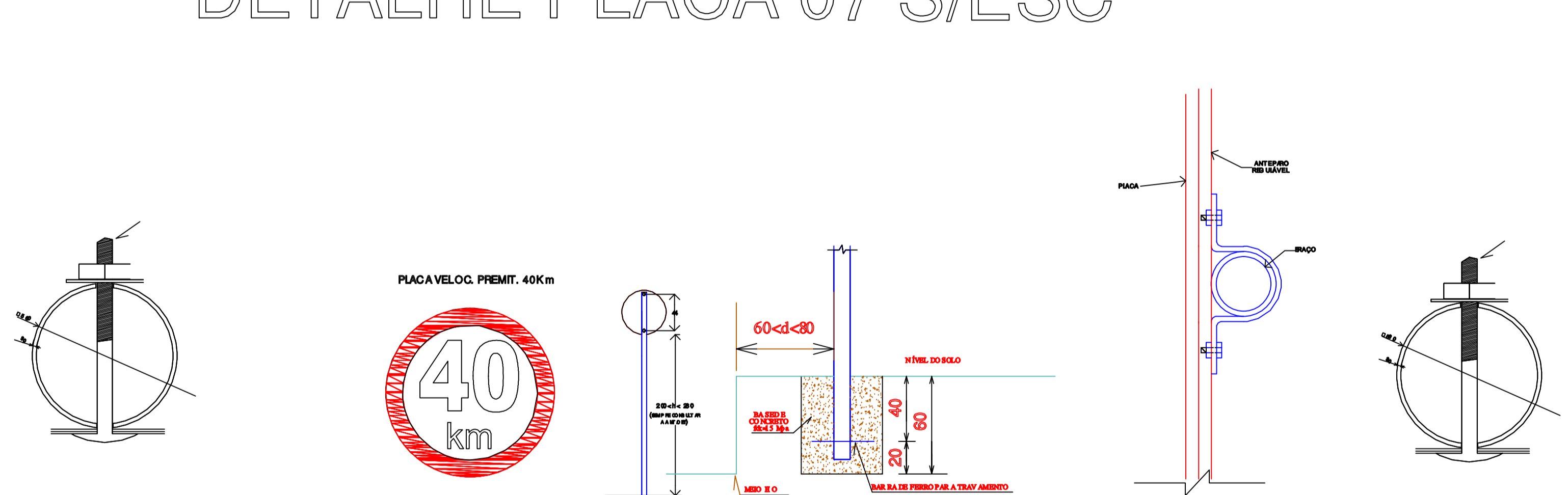

DETALHE PLACA 09 S/ESC

SURDI CONSTRUÇÕES LTDA ME			
Rua Heracides Vieira Borges n° 490 FONE 49 9981-2978	TÍTULO	SINALIZAÇÃO VIÁRIA	PRANCHA
	REFERENCIA	PAV DA RUA JOSÉ FAQUIM E RUA JOSÉ DAROL	P/10
	PROPRIETARIO	PREFEITURA FREI ROGÉRIO CPF/CGC	ASSINATURA
	RESPONSÁVEL TÉCNICO	ENG. CIRO FONTANA SURDI CREA/SC 063545-0	EMPRESA
	DESENHO	01	PREFEITURA
	ESCALA	INDICADA	
	DATA	15/04/2015	